



# The Iwakura Garden

---





**The Iwakura Garden - Model Scale 1:45**



**Southeast corner of the garden, stone seating area shaded by cloud pruned pine:** Details include stepping stones set into grass, trees (including cloud pruned pine), smaller bushes, hand modelled stone seats softened with long grasses all set on a banked area.

## The Iwakura Garden – Detail





**The circular stone structure with Iwakura stones and hidden Lilly pond:** This was a particularly complicated part of the model. The circular stone structure was modelled with mounting board and painted with acrylic paint to resemble layered slate patterns. The Iwakura stones forming the focal point of the garden were carefully hand modelled to the required shape and size, before painting. The pond was lined with plaster bandage, trimmed and sealed with acrylic paint before being filled with Realistic Water resin. The Lilly plants were embedded in the resin and gradually opened out to give a natural appearance as layers of resin were built up over 5 days.

## The Iwakura Garden – Skill

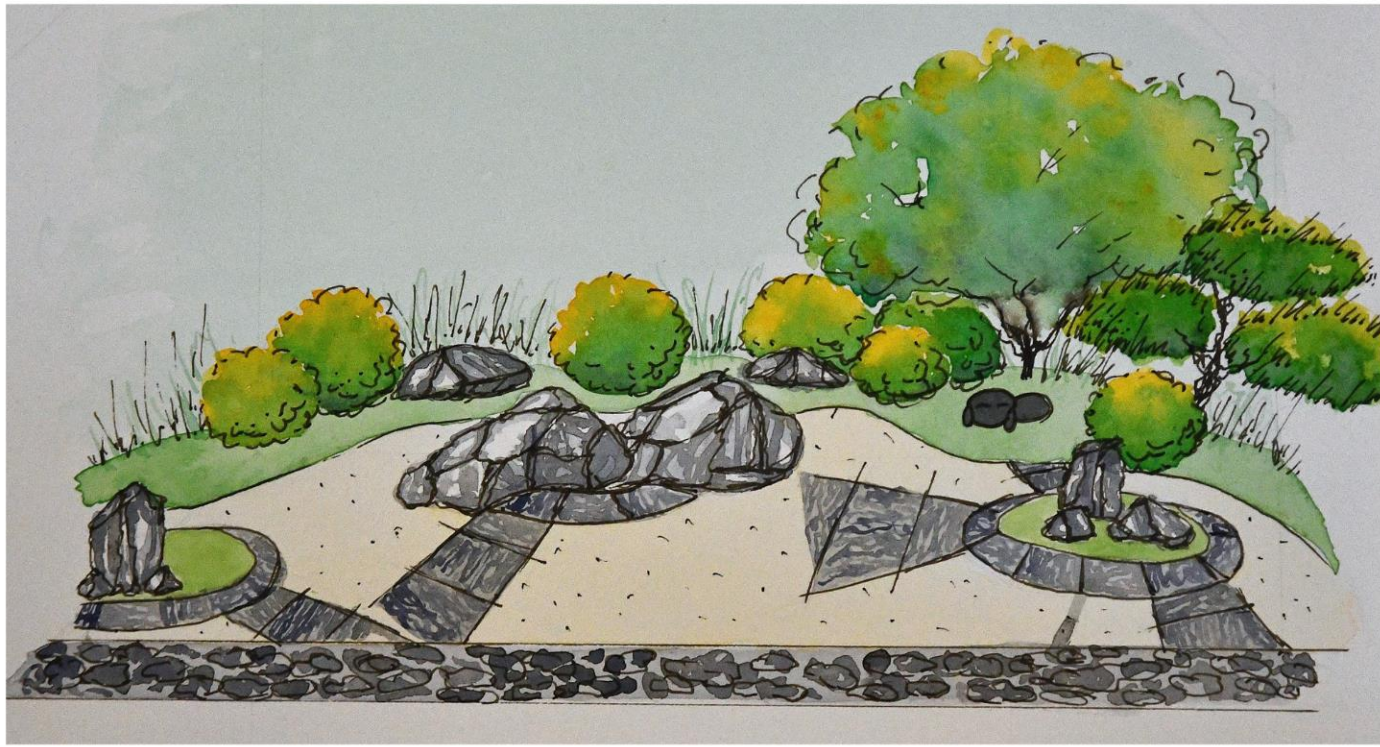

**Watercolour Painting:** One purpose of my EPQ was to support my application to study Landscape Architecture, the output would form my portfolio. The portfolio required work using a range of techniques and media and to demonstrate an ability to see perspective.

During the early part of the project I used online courses to learn how to draw and paint in watercolour to illustrate my designs. These watercolour sketches were used in the design process to translate the plan for my garden into an elevation view which hopefully provided the client with a clear impression of the design.

## The Iwakura Garden – Technique



**The Iwakura Garden – Form**

